



NAJA D301-L Dante Gooseneck Microphone

User Manual

Caution

To ensure the reliable use of the equipment and the safety of personnel, please observe the following matters during installation, use and maintenance:

1. When installing the equipment, make sure that the ground wire in the power line is well grounded and that the base grounding point is properly connected.
2. Keep the working environment well ventilated so that the heat generated by the equipment at work can be discharged in time to avoid damage to the equipment due to high temperature.
3. Turn off the main power supply of the equipment when it is not in use for an extended period or in a humid and dewy environment.
4. Be sure to unplug the AC power cord of the equipment from the power outlet before the following operations:
 - A. Remove or reinstall any part of the equipment.
 - B. Disconnect or reconnect any electrical plugs or connections to the equipment.
5. Do not disassemble the equipment without permission from professionals to avoid the risk of electric shock. Do not attempt to repair the equipment privately, as this may aggravate the damage.
6. Do not spill any corrosive chemicals or liquids on or near the equipment

TABLE OF CONTENTS

Chapter 1 Product Introduction 1

 1.1 Introduction 1

 1.2 Product Features 1

Chapter 2 Specifications1

Chapter 3 Device Size3

Chapter 4 Description of the use of the interactive interface 4

Chapter 5 Device Operation5

 5.1 Connecting the device correctly 5

 5.2 Use5

 5.3 Dante Network Audio Routing 5

Chapter 1 Product Introduction

1.1 Introduction

This is a Dante interface desktop microphone, which can realize the conversion of analog audio signals to Dante digital audio signals, long-distance transmission through Dante interface, and power supply through POE. The supported POE standards are IEEE 802.03af, IEEE 802.03at, which provide a high-quality sound pickup solution with low latency and simple wiring. Built-in high-performance embedded CPU, faster processing speed, refined structural design, all-metal microphone pole design, exquisite surface treatment, showcasing exquisite craftsmanship of modern industry. High-fidelity, high sensitivity microphone, super-cardioid pickup effect, high-quality pickup guarantee, the best pickup distance 40-80 cm, physical on/off switch for microphone.

1.2 Product Features

- ✧ High-fidelity Microphone capsule serves as a guarantee for high-quality sound pickup, the microphone is designed with all-metal material.
- ✧ The high-Sensitivity capsule offers Super-cardioid pickup effect, with an optimal pickup distance of 10~50CM.
- ✧ It is equipped with a physical on/off switch for the microphone.
- ✧ The system unit provides Dante digital audio output interface;
- ✧ 802.3af、802.3at Standard POE switch power supply;
- ✧ Simple audio routing, configure audio routing through Dante Controller.

Chapter 2 Specifications

Pickup	High sensitivity condenser microphone
Output interface	1 RJ45, transmitting 1 channels of Dante network audio
Directionality	Supercardioid

Frequency Response	100Hz~16KHz
Sensitivity	-40dB
Maximum Sound Pressure Level	110dB (3%T.H.D.@1kHz, 0dBSPL=2x10Pa)
Equivalent Noise Level	<25dBSPL(A)
Signal-to-Noise Ratio	65dB, 1kHz
Overload Harmonic Distortion	<1%
Sampling Rate	48kHz
Bit Depth	24-bit
Operating Temperature and Humidity	0℃~40℃, 10%~90%RH, No condensation
Network Transmission	Dante IP/AES67/RTP Audio
Dante Device Latency	1、 2 or 5ms (Configurable using Dante Controller)
Power Supply	802.3af、 802.3at Standard POE switch
Maximum Power Consumption	1.5W
Microphone pole size	42m
Chassis Dimensions (L×W×H)	149mm×94.1mm×55.4mm
Weight	0.9kg
Package Dimensions (L×W×H)	400mm×160mm×85mm
Package Weight	1.4kg

Chapter 3 Device Size

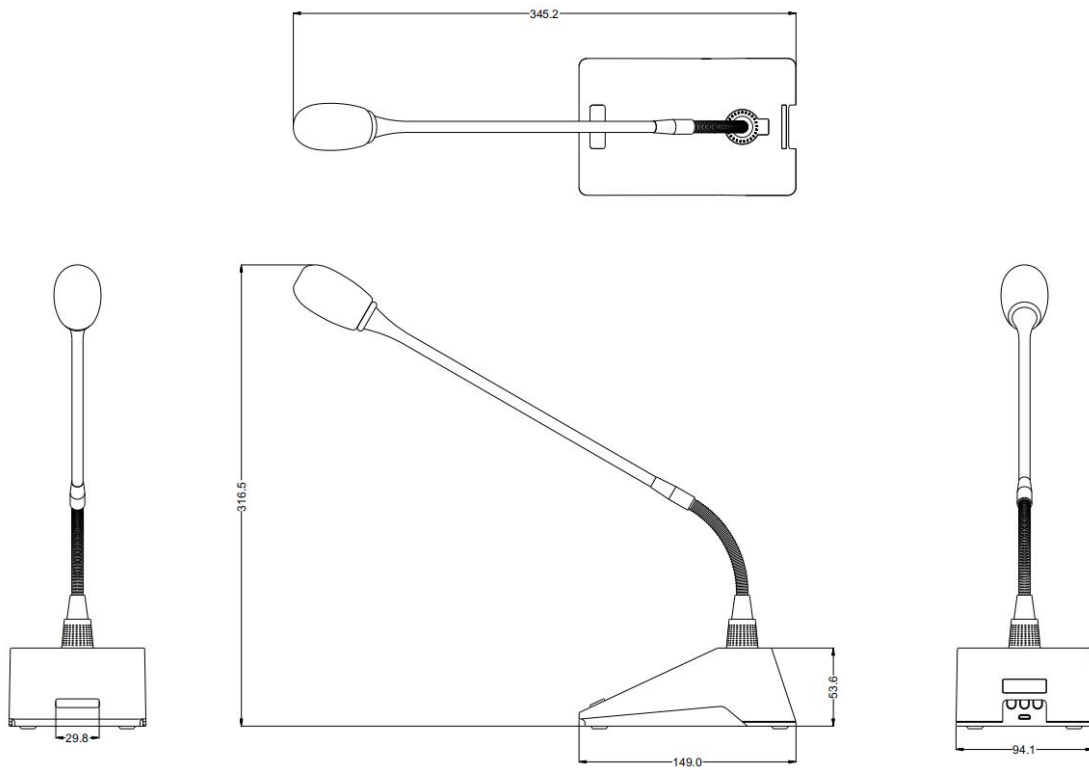

Chapter 4 Description of the use of the interactive interface

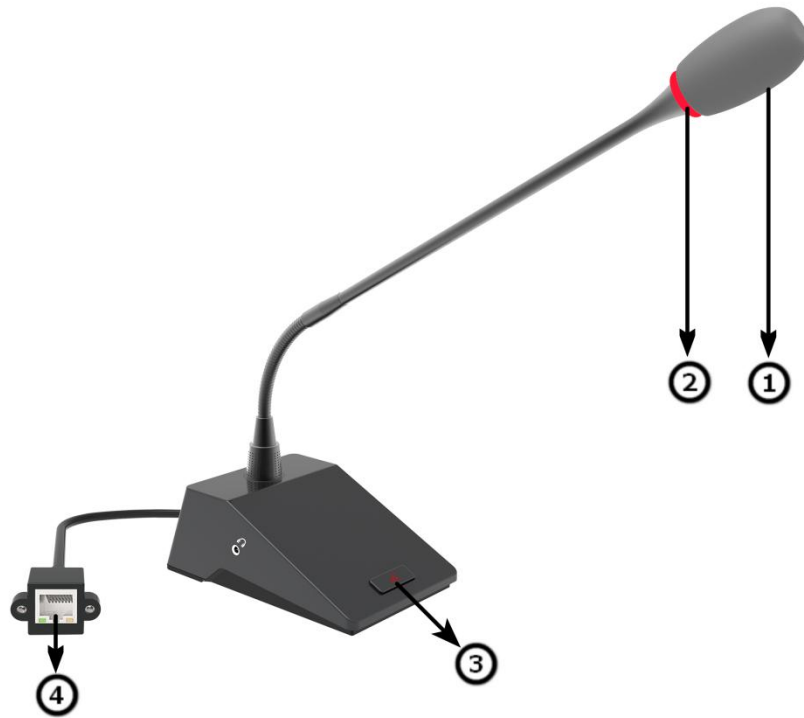

- ① Microphone head: Used for picking up sound;
- ② Indicator light: Long light indicates that the microphone is on; no light indicates that the microphone is off;
- ③ Key switch: Turn on or off the microphone;
- ④ POE function Dante interface: POE supply and DANTE audio output.

Chapter 5 Device Operation

5.1 Connecting the device correctly

This device transmits audio signals and supplies power to the device at the same time through a single network cable, so it needs to be connected to a switch or other routing device that supports the POE power supply function. Use a CAT5E or higher standard network cable. (Please note that Dante does not work with Wi-Fi connections, and relies on a reliable and secure wired network to deliver perfect audio.) The Dante Network Microphone is connected to the Dante network and requires software to configure the signal routing to output its audio signal. Open Dante Controller software, it can automatically scan all the Dante devices in the network, in the Routing page, the input row and output column will be customized to check that the matching is completed.

5.2 Use

After connecting the power and routing and matching the input and output signals of Dante network through the software, press the switch button, the red indicator light is on, then it starts to pick up the sound, and then press the light off again then it enters into the mute state, realizing to turn on or off the microphone.

5.3 Dante Network Audio Routing

In a Dante audio network, the Dante Controller software is required to set up the routing of the various signals accessing the processor. It can realize 1-to-1, 1-to-N mapping operation from input to output within Dante network.

Note:

1, Dante can not run in the Wi-Fi wireless connection environment, is dependent on a reliable and secure wired network environment to transmit perfect audio;

2, Dante Controller software corresponds to the platform of Windows 7, Windows 10, Windows 11, macOS, please select the appropriate software version according to your system platform.

[Click to download the official Dante Controller software Dante Controller](https://www.audinate.com/products/software/dante-controller)

(<https://www.audinate.com/products/software/dante-controller>)

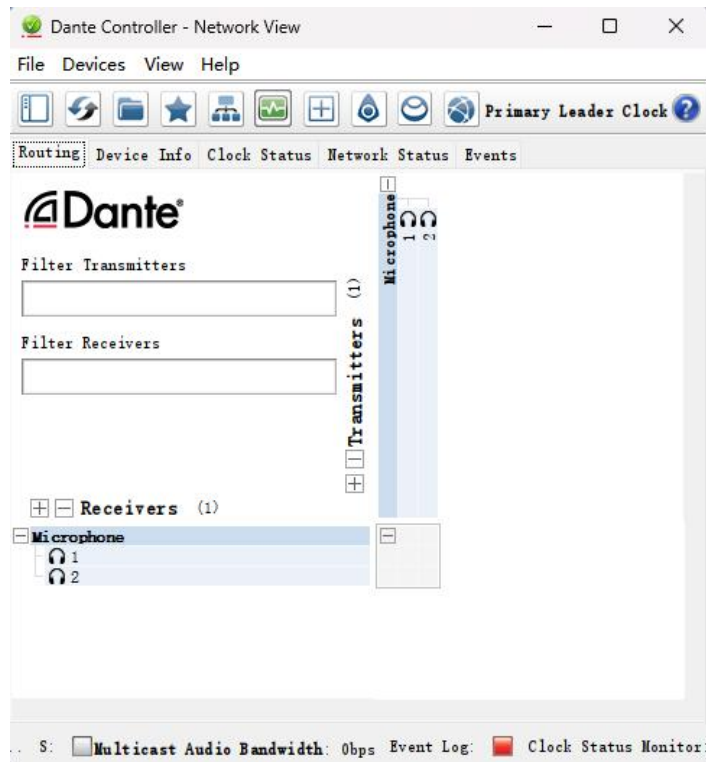

Warranty Regulations

The warranty period of this product is 1 year.

In the warranty period of non-man-made damage caused by the product performance failure can enjoy three packages of service.

Warranty card by the sales unit stamped after the effective. The alteration is invalid!

The following conditions (including, but not limited to, this) are not covered by the three-package service:

1. No warranty card or missing valid invoice or the date has exceeded the validity period of the three packages of services;
2. Not in accordance with the requirements of the product instructions for use, maintenance, management and damage caused;
3. The product model or code on the warranty voucher does not match the physical goods;
4. Damage caused by the dismantling and repair of non-authorized service providers;
5. Normal discolouration, wear and tear and consumption during the use of the product are not covered by the warranty;
6. The product cannot be used due to the user's own network reasons, please consult customer service staff.



SHENZHEN S TRACK SCIENCE TECHNOLOGY CO., LTD

Web: www.s-track.com.cn

Tel: +86 755 29983191

Mail: service@s-track.cn

Add: 9F, 1B, Shangzhi Technology Park, Guangming District, Shenzhen City, Guangdong Province, China 518107